

PIN #	COLOR
1	GREEN / YELLOW
2	BLACK
3	WHITE

RECOMMENDED PANEL THICKNESS: [1.5 - 3.5] 0.060 - 0.138

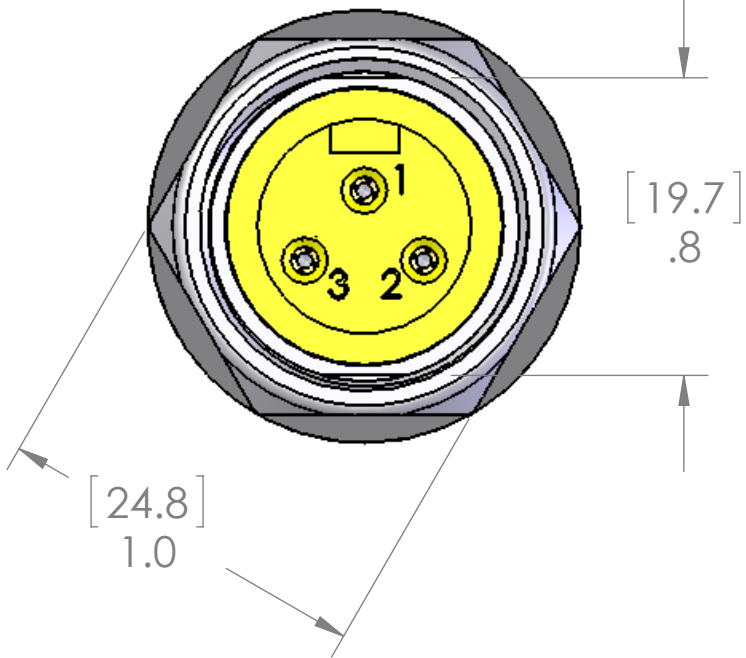

7/8-16 UN2A

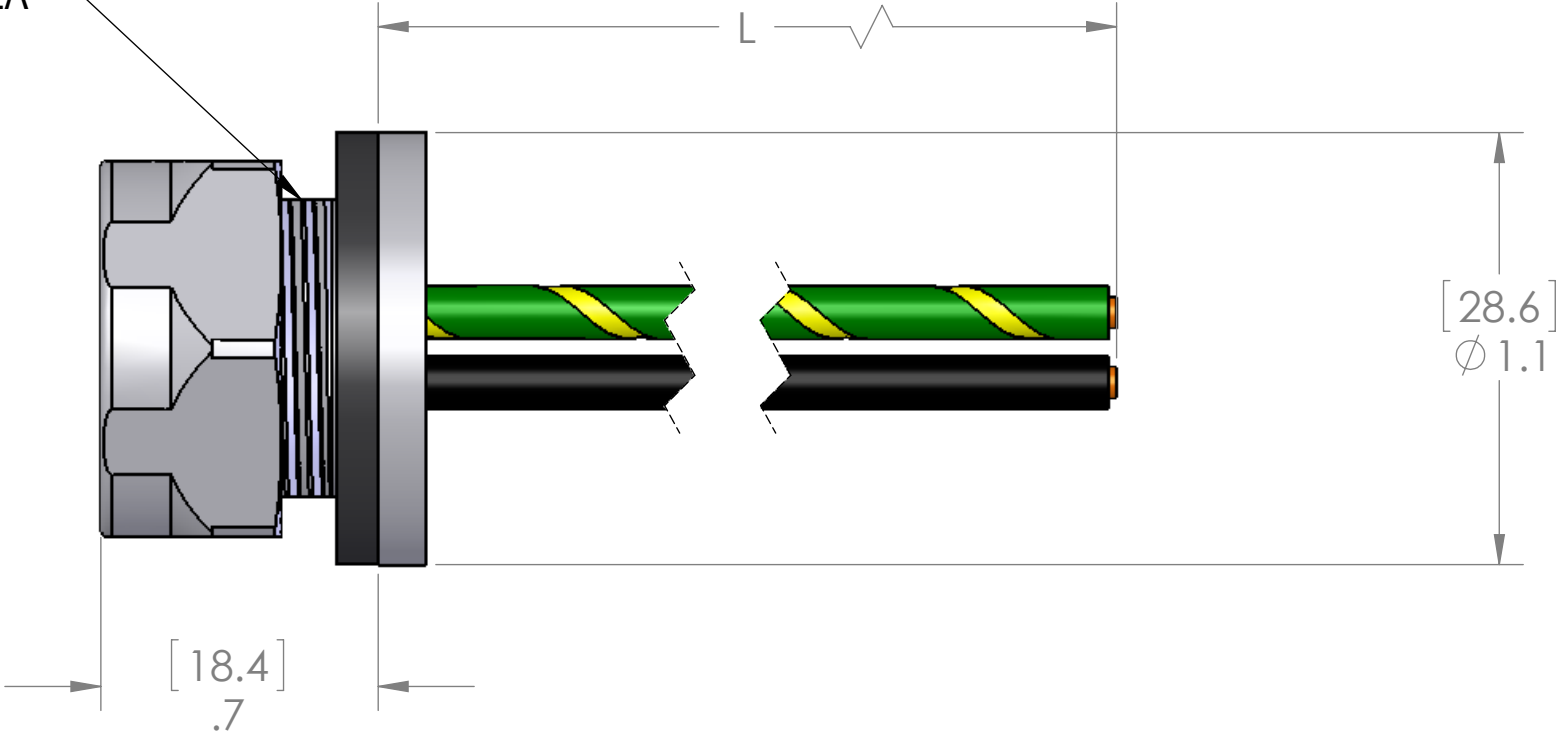

RECOMMENDED  
CUT-OUT

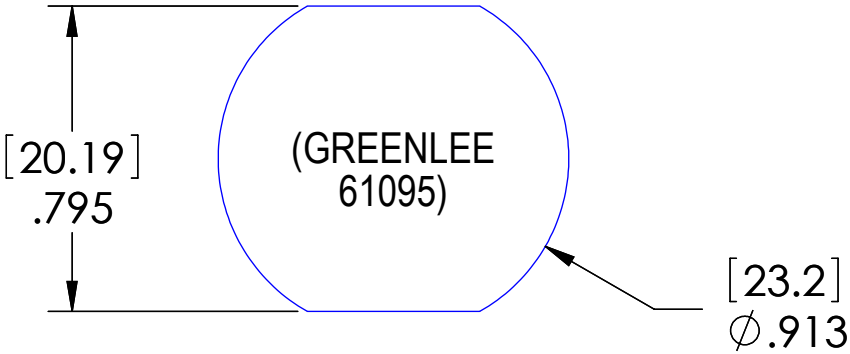

MATERIALS	
BODY:	NICKEL PLATED BRASS
CONTACTS:	GOLD PLATED COPPER ALLOY
INSERT:	YELLOW PVC
WIRE:	14AWG UL1015
GASKET:	NBR
JAM NUT:	NICKEL PLATED BRASS

APPROVALS	
U.S.	UL LISTED
CANADA	C-UL LISTED

REVISIONS			
REV.	DESCRIPTION	DATE	APPROVED
A	DRAWN IN SW	4/30/2015	BEM

P/N	L
MINH-3FR-1-BM	12" [0.3m]
MINH-3FR-2-BM	24" [0.6m]
MINH-3FR-3-BM	36" [0.9m]
MINH-3FR-4-BM	48" [1.2m]
MINH-3FR-6-BM	72" [1.8m]
MINH-3FR-10-BM	120" [3.0m]
MINH-3FR-15-BM	180" [4.6m]
MINH-3FR-20-BM	240" [6.1m]

UNLESS OTHERWISE SPECIFIED:	NAME
DIMENSIONS ARE IN INCHES AND [MM]	JJH
INTERPRET GEOMETRIC TOLERANCING PER:	
MATERIAL	
FINISH	
APPLICATION	DO NOT SCALE DRAWING

MENCOM CORPORATION

TITLE:  
3 PL FEM RCP ZZ' 14AWG BK MT

SIZE	DWG. NO.	REV
B	MINH-3FR-ZZ-BM	A
SCALE: 2:1	WEIGHT:	SHEET 1 OF 1