

E10743

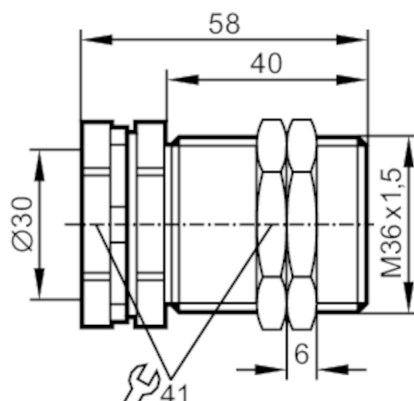

Mounting sleeve with end stop

FIXING/M30/BASIC/MS/END STOP



Application

Design	with end stop
--------	---------------

Mechanical data

Weight	[g]	192.7
Installation instruction	Align the sensing face of the sensor to the right (see scale drawing)	
Dimensions	[mm]	M36 x 1.5 / L = 58
Thread designation		M36 x 1.5
Inside diameter	[mm]	30
Material	brass white bronze coated; Nuts: brass white bronze coated	
Tightening torque	[Nm]	20; (lock nuts: 40)

Accessories

Items supplied	Nuts: 2
----------------	---------

Remarks

Pack quantity	1 pcs.
---------------	--------