

PANEL CUTOUT

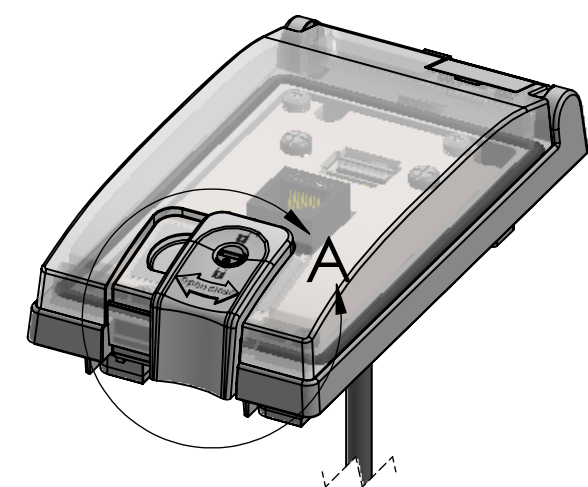

SLIDE LATCH TO OPEN/CLOSE  
ROTATE LOCK TO LOCK CLOSED

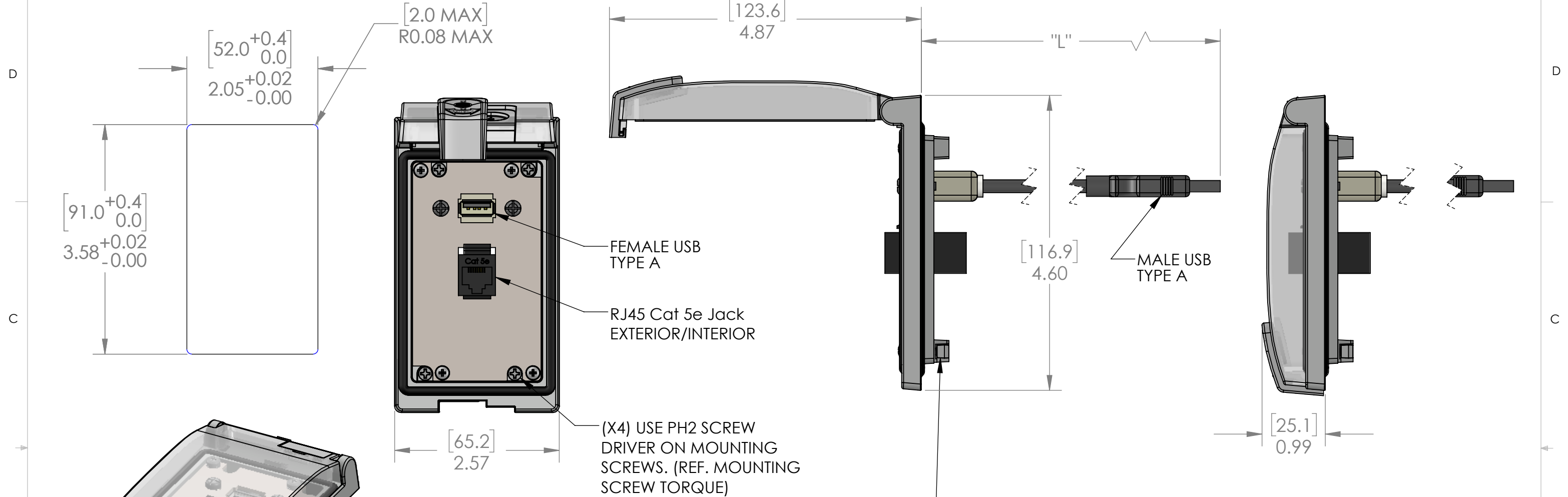
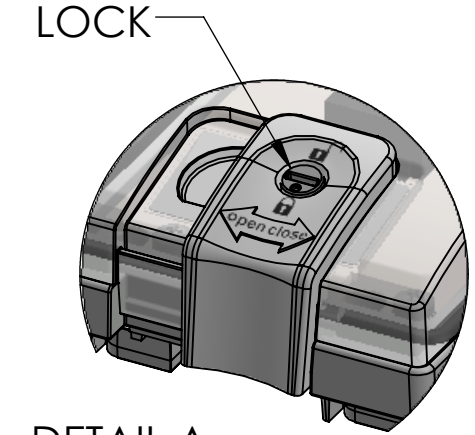

DETAIL A  
SCALE 1 : 1

**PROPRIETARY AND CONFIDENTIAL**  
THE INFORMATION CONTAINED IN THIS DRAWING IS THE SOLE PROPERTY OF MENCOM CORPORATION. ANY REPRODUCTION IN PART OR AS A WHOLE WITHOUT THE WRITTEN PERMISSION OF MENCOM CORPORATION IS PROHIBITED.

HOUSING MATERIALS	
BODY:	NICKEL PLATED ZINC
GASKETS:	PUR / FIPG
FRONT COVER:	POLYCARBONATE
LATCH & LOCK:	PBT

UNLESS OTHERWISE SPECIFIED:	
DIMENSIONS ARE IN INCHES AND [MM]	
MATERIAL	
FINISH	
DO NOT SCALE DRAWING	



These devices shall be mounted on enclosures having adequate strength and thickness and with adequate spacing provided. Seal rating is based on mounting to a surface that is clean, flat and smooth.

PIC RATINGS/SPECIFICATIONS			
NEMA/UL   EN 60529:		4, 12   IP65	
PANEL THICKNESS:		5.0mm max	
MOUNTING SCREW TORQUE:		0.8N-m	
DRAWN BY	DG	MENCOM CORPORATION  TITLE:  RJ45; USB ZZ; LP1	
DRAWN DATE	09/29/2017		
CHECKED BY	DWM		
CHECK DATE	10/09/2017		
COMMENTS:		SIZE DWG. NO. REV	
		B LP1-RJ45-USB-ZZ B	
SCALE: 2:3		WEIGHT:	SHEET 1 OF 1