

SAGINAW CONTROL & ENGINEERING

SCE-P011006

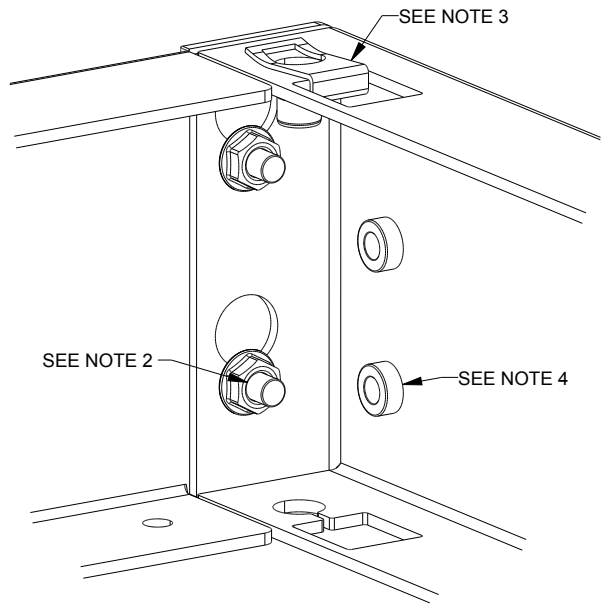

- CONSTRUCTION NOTES:
1. THE PLINTH BASE IS A BOLT TOGETHER CONSTRUCTION.
 2. THE BASE WILL BE BOLTED TOGETHER USING 1/4-20 HARDWARE, WHICH IS INCLUDED IN THE BOLT PACK.
 3. 5/8-16 "U" NUTS & BOLTS, FOR SECURING TO AN IMS ENCLOSURE, ARE ALSO INCLUDED IN THE BOLT PACK.
 4. 1/4-20 PEM NUT PROVISIONS IN THE SIDE CHANNELS FOR ATTACHING OPTIONAL MOUNTING ANGLES.

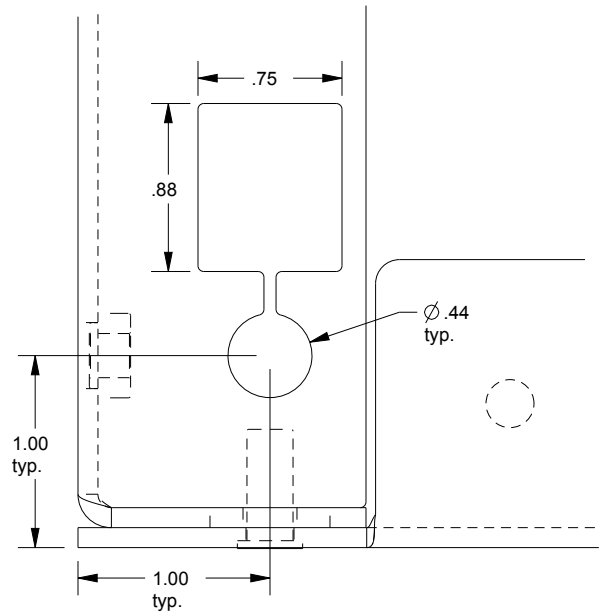